



QUICK SET-UP GUIDE

T214B • T314B • T414S

A. SET-UP



NOTE:
Bottled or filtered water
is recommended.



1 Remove adhesive tapes.
Unwrap the Power Cord.

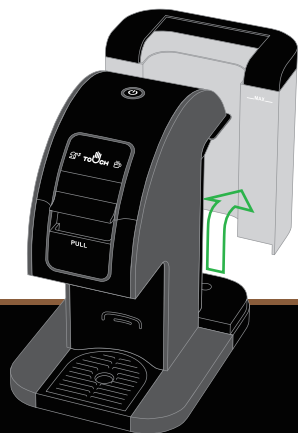

2 Remove the Water Tank by
tilting and lifting away from
the Brewer.

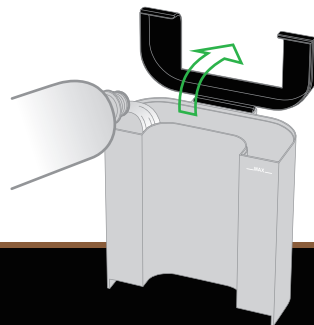

3 Rinse the Water Tank several
times. Fill with water.



4 Place the Water Tank and
Lid back on to the Brewer.

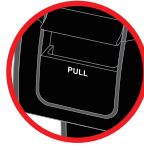

WARNING:
DO NOT pull the Latch
while brewing.



NOTE:
The first brewing cycle may take
up to 30 seconds to start.



5 Plug the Power Cord into
an electrical outlet.
Press the Power Button.



6 Place a large mug or cup
on the Drip Tray. (min. 12oz)



7 Press on the 10 oz Cup Size
Button to start brewing.

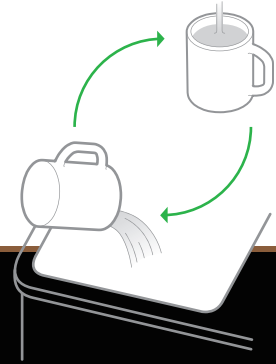

8 Discard the hot water and
repeat steps 6 and 7 at least
two (2) more times.

B. BREW

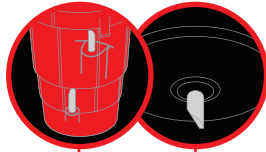

⚠ WARNING:
Sharp Needles on the Top Cover
and in the Red Cup Holder.

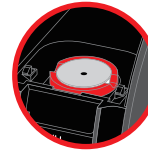

⚠ WARNING:
Coffee Pod may be HOT.

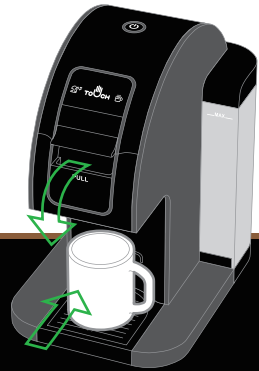

9 Place a mug on the Drip Tray and lift the Cover by pulling on the Latch.

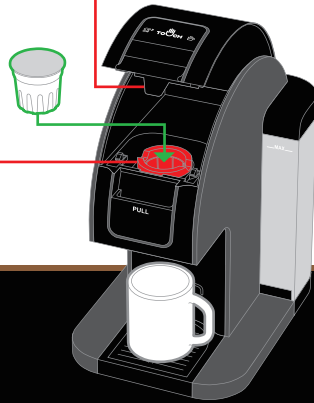

10 Insert a coffee pod into the Red Cup Holder. Close the Cover.

T214B

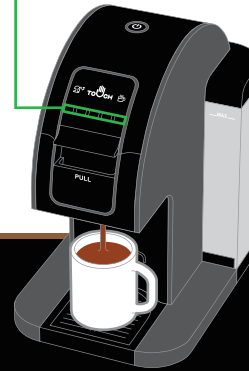

11 Press the desired Cup Size Button to start brewing. Enjoy your beverage!

T314B / T414S



T314B / T414S ONLY: The default taste setting is BOLD, but this can be changed by pressing either MILD or MED.